

Other Specialty OEM  
Brake Drum Interchange  
(K-B Axle, Lodal, Euclid)



Contact us for information on one of our  
thousands of part numbers not in this list

Headquarters and Mailing Address:

DuraBrake Co.  
PO Box 1480  
Los Altos, CA 94022  
Phone: (650)949-5365  
Fax: (650)949-5371  
Email: [info@durabrake.com](mailto:info@durabrake.com)

[www.durabrake.com](http://www.durabrake.com)

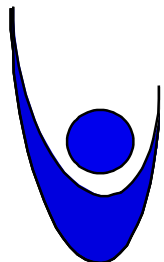
  
DURABRAKE CO.

# ***DuraBrake Brake Drums***

**DuraBrake Co. was started as Durametal Brake Co. in 1998 upon the acquisition of the brake drum business from Durametal Corporation in Tualatin, Oregon. DuraBrake strives to remain the leader in quality, high-performance specialty brake drum market for truck, bus and off-highway vehicles. This is possible by continuing to use the processes and quality systems established at Durametal Corporation over their 50 year history.**

**We have hundreds of part numbers in our catalog that are stock items or can be produced upon request in any quantities. Over 2000 custom part numbers have been made from the existing in-house patterns. These part numbers are well-known in the industry and are the same part numbers used by Durametal. Customers for these parts include distributors and end-users.**

**DuraBrake is a highly visible company known as the leader in specialty replacement brake drums for truck/bus/off-highway equipment. We are gaining market share in the truck and transit commodity replacement market with our high-quality, versatility, and cost-competiveness. Since 1948, DuraBrake\* drums have served the truck, trailer, and transit industries with the HIGHEST QUALITY and SERVICE unmatched in the industry.**

## **DuraBrake Drums...**

**...Are engineered to meet every type of braking application and road condition.**

**...Are made of the finest, controlled close-grain, high tensile iron, which means longer life and even wear.**

**...Are precision machined and individually inspected to insure each meet rigid standards for MAXIMUM BALANCE and PERFECT FIT.**

**In keeping with our commitment to HIGH QUALITY and SERVICE, we are constantly improving our engineering, foundry, machining, and testing techniques to provide the SAFEST, LONGEST LASTING, and MOST ECONOMICAL brake drum made.**

**\* Prior to 2002, DuraBrake drums were made under the name Durametal Brake Co. Prior to 1997, DuraBrake drums were made by the same patterns, equipment and process technology utilized by Durametal Corp.**

### CHART OF DRUM STYLES

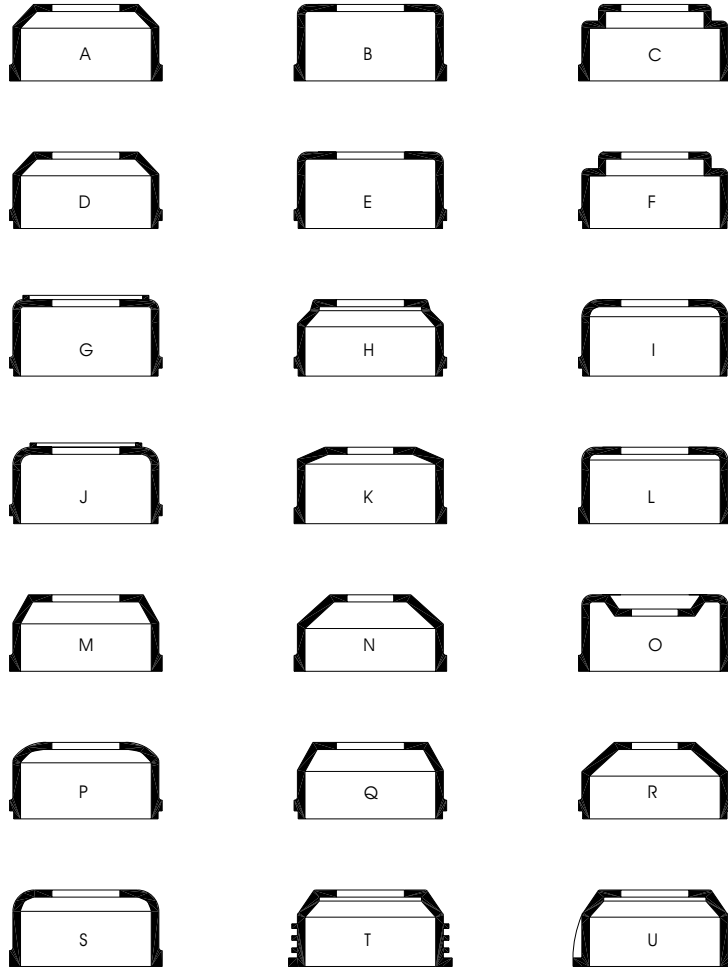

### INFORMATION REQUIRED FOR DRUMS NOT LISTED

Type of Drum (as shown on chart)

**Dimensions:**

- A - Inside Diameter
- B - Overall Depth
- C - Bolt Circle Diameter and Number of Studs
- D - Outside Diameter
- E - Hub Pilot Diameter
- F - Brake Face Width
- G - Back Face Width
- H - Dust Shield Diameter
- I - Dust Shield Depth
- J - Out Board Pilot Diameter

Drums made to customer specifications are not returnable

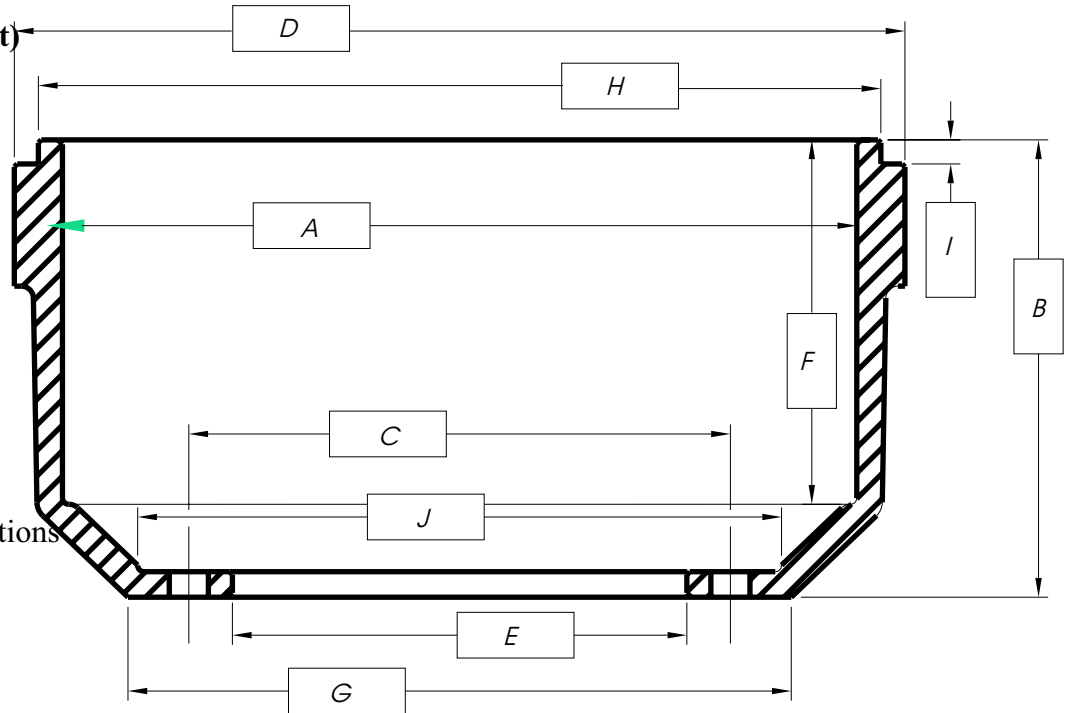

DuraBrake (formerly Durametal Brake) is a leader and pioneer for aftermarket specialty brake drums including obsolete and active original equipment (OE) brake drums as in the partial list below. Please call us at (650)949-5365 or email sales@durabrake.com for pricing,

Euclid		K-B Axle (continued)*	
Euclid Part	DuraBrake Part	K-B Axle Part	DuraBrake Part
9110071	2028	3U-168-17	16290
9111019	2026	4U-18-1	18141
9115689	2029	4U-18-3	1814
9125682	2602	4U-18-8	18143
9143220	2029	4U-18-9	18142
9163507	2603	4U-20-1	2005
9200118	2026	5U-174-1S	1712
9205580	2026	5U-174-5S	1713
		5U-20-1	20031
		5U-20-2	20031
		5U-20-3	20051
		5U-20-4	20051
		5U-20-5	20032
		6U-20-1	2002
		6U-20-10	2001
		6U-20-2	2000
		6U-20-3	2011
		6U-20-4	2013
		6U-20-8	2009
		6U-20-9	2003
		7U-168-1	1697
		7U-168-2	1697
		7U-20-1	2005
		7U-20-2	20053
		7U-20-3	20053
		8U-16-1	1522
		8U-16-3	1520
		8U-168-1	16991
		8U-168-2	16991
		8U-20-1	20031
		8U-20-2	20031
		8U-20-3	20051
		8U-20-4	20051
		8U-20-5	20032
		8U-20-6	20091
		92U-174-8	17111
		9U-20-1	20031
		9U-20-2	20051
		Q-12-8	1207
K-B Axle*		Lodal	
K-B Axle Part	DuraBrake Part	Lodal Part	DuraBrake Part
10U-168-2	16290	2128789	15789
10U-168-3	16290	2128790	15790
13U-168-1	16975		
14U-16-15	1536		
14U-16-3	1533		
14U-16-33	1533		
14U-5-1	1535		
15U-16-1	1529		
15U-16-3	1525		
15U-16-5	15136		
15U-168-1	16991		
16U-16-4	1520		
16U-168-1	16290		
16U-173-3	1708		
19U-168-1	16975		
19U-174-1	1711		
19U-174-10	1713		
19U-174-2	1712		
19U-174-9	1714		
20U-174-4	1712		
20U-174-5	1713		
2U-20-1	2002		
2U-20-10	2001		
2U-20-2	2000		
2U-20-8	2009		
2U-20-9	2003		
3U-12-1	1201		
3U-12-10	1218		
3U-12-12	1221		
3U-12-2	1203		
3U-12-3	1202		
3U-12-4	1217		
3U-12-8	1208		

\*K-B Axle refers to the original designer of these drums. This interchange pertains to Dexter Axle and Columbia Corp. as well.